

**SURFACE MOUNT BENCH
INSTRUCTIONS
BM1145 - BM1155**

REV# 1

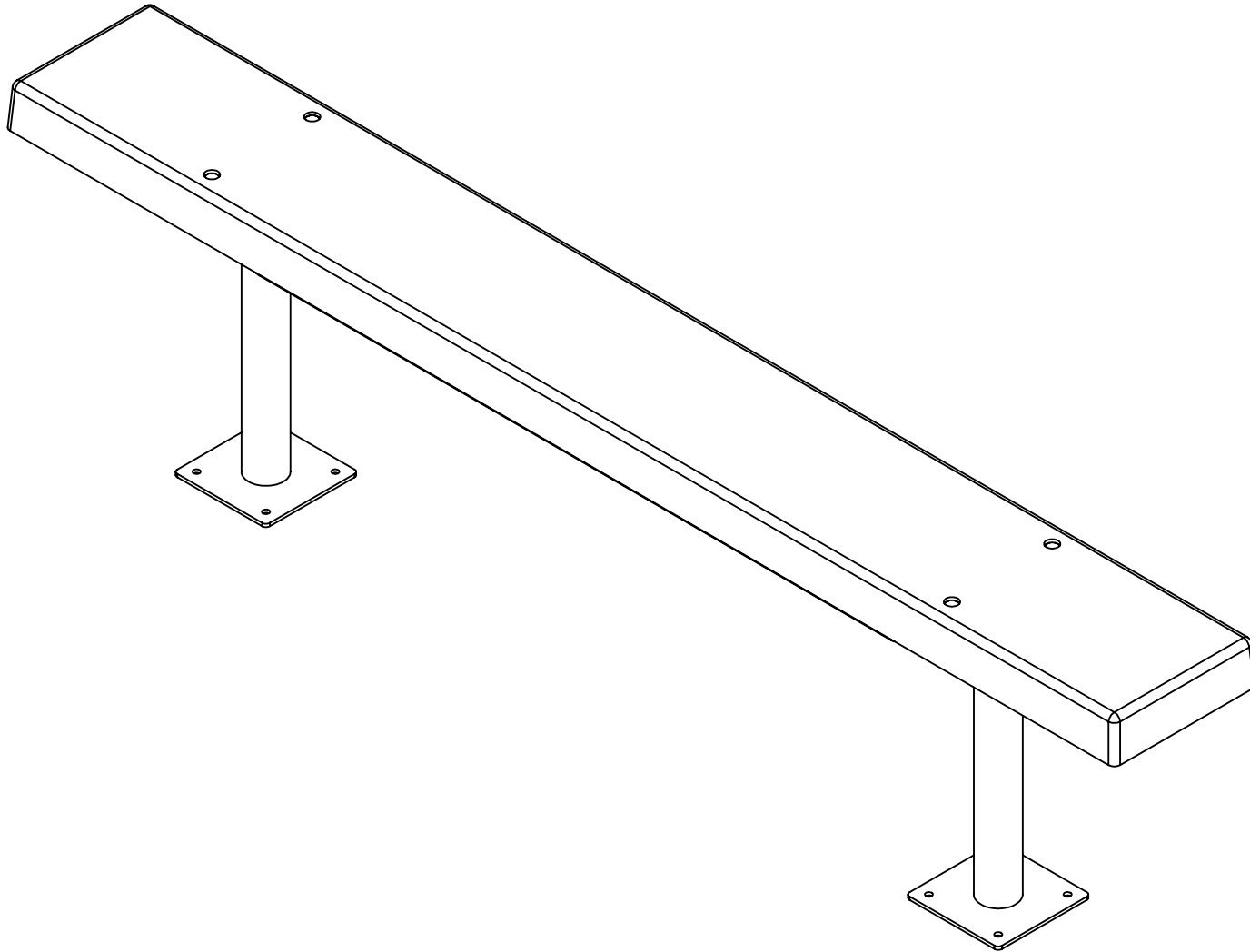

SURFACE MOUNT BENCH INSTRUCTIONS BM1145 - BM1155

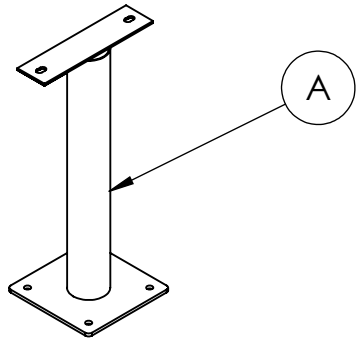

2
STEEL BENCH END

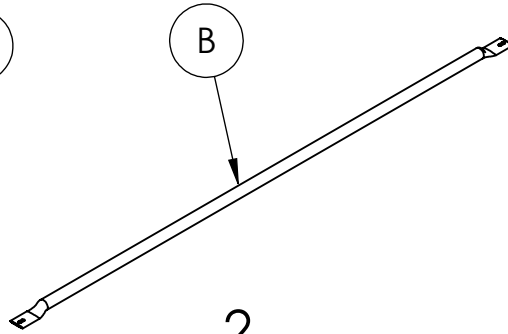

2
STEEL TUBE SUPPORT

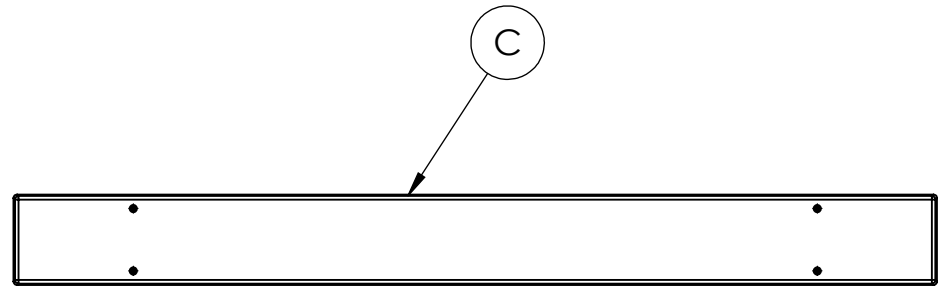

1
PLASTIC BOARD

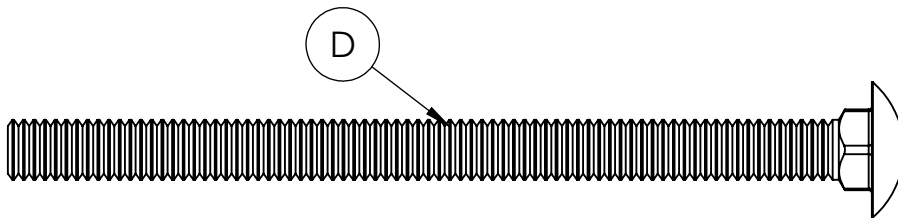

4
4-1/2" X 5/16" CARRIAGE BOLT

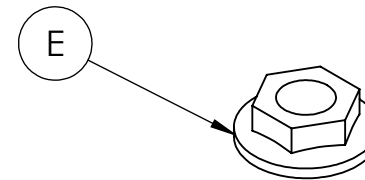

4
5/16" FLANGE NUT

REQUIRED TOOLS (NOT INCLUDED)

- 1 - 1/2" WRENCH
- 1 - 1/2" SOCKET

NOTE: IT IS IMPORTANT TO KEEP ALL BOLTS FINGER TIGHT DURING ASSEMBLY UNTIL ENTIRE TABLE IS ASSEMBLED

**HARDWARE &
TOOLS REQUIRED
FOR ASSEMBLY**

2/3

SURFACE MOUNT BENCH INSTRUCTIONS BM1145 - BM1155

STEP 1

- Set the two steel bench ends 45 inches apart (68.5 inches for 8ft bench)
- Lay 2 tube supports (B) over the steel bench ends (A)
- Lay the board (C) over the tube supports (B) and the steel bench ends (A)
- Insert four 3-1/2" x 5/16" carriage bolts (C) into the holes in the boards (B), tube supports and steel bench ends
- Hand tighten with two 5/16" flange nuts (D)

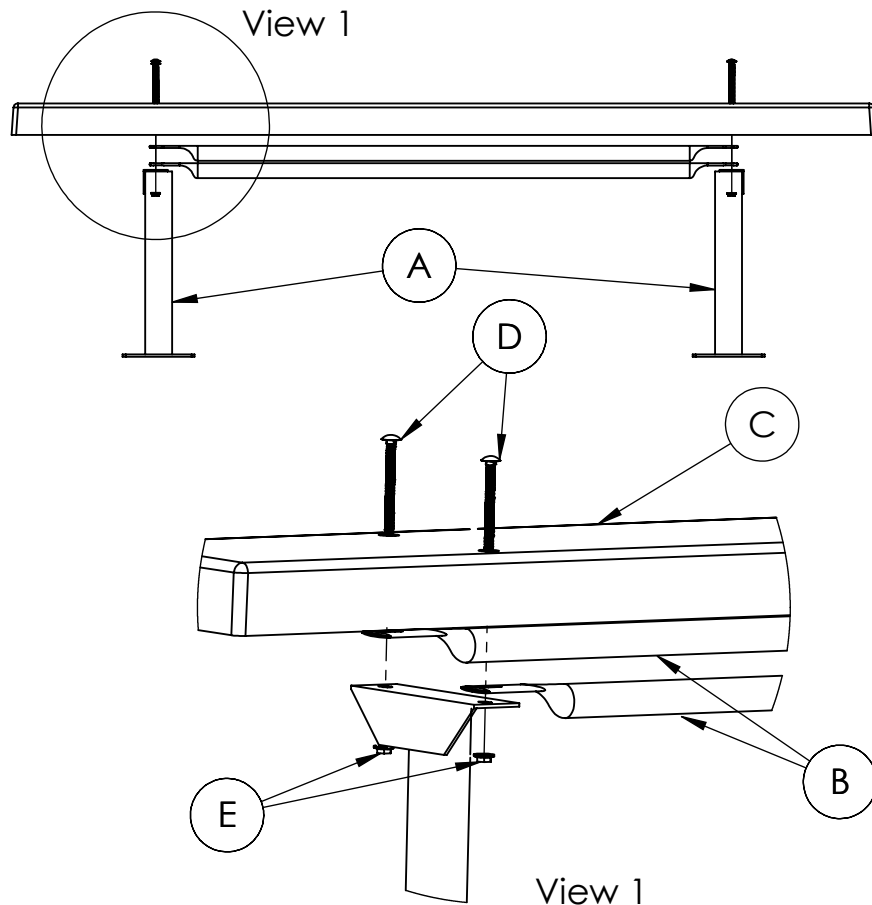

STEP 2

- Square all parts and tighten all hardware
- Install on a flat level surface with appropriate hardware

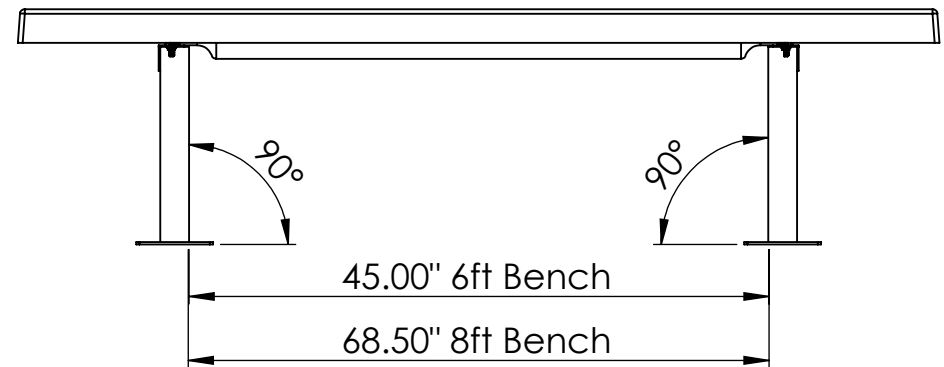

SURFACE MOUNT BENCH SPECIFICATIONS

BM1145 - BM1155

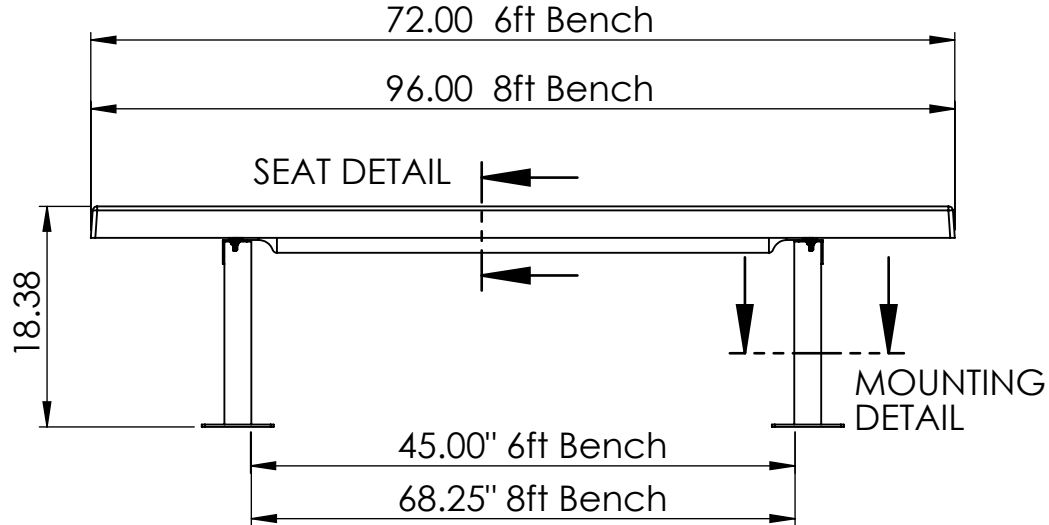

FRONT

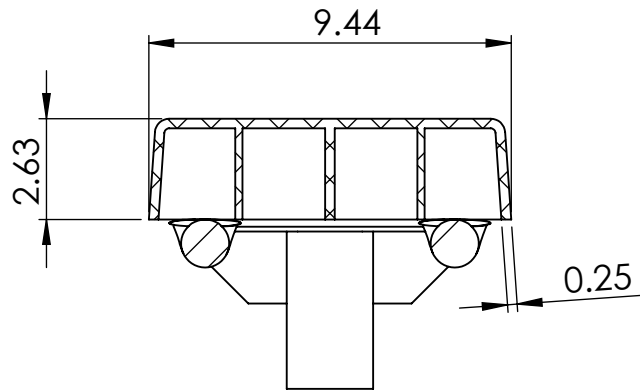

SEAT DETAIL

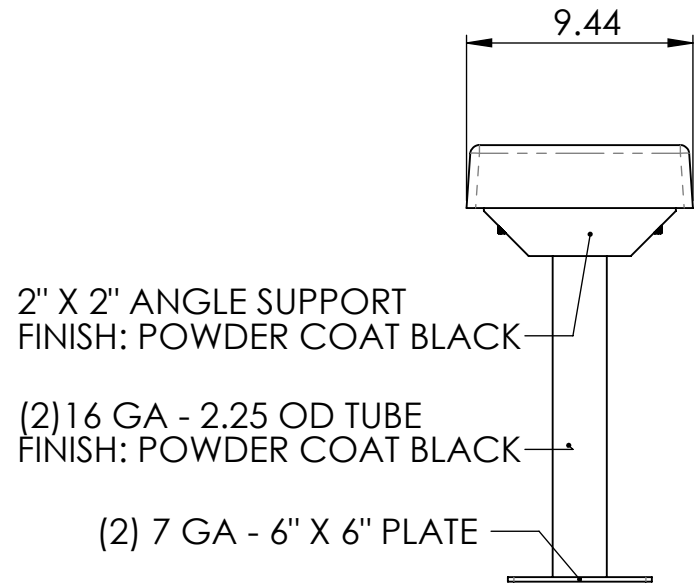

SIDE

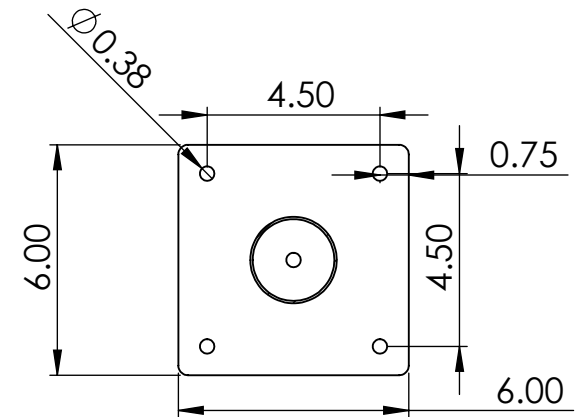

MOUNTING PLATE DETAIL

MATERIALS: Plastic, Powder Coated Steel
HARDWARE: Zinc Plated

ALL DIMENSIONS ARE SHOWN IN INCHES